

Quick Setup Guide

Congratulations on the purchase of your new Samsung TV.
Read this setup guide to get your TV up and running quickly.

SERIES **6**
6300



1-800-SAMSUNG (1-800-726-7864)
Samsung Electronics America, Inc.
85 Challenger Road Ridgefield Park, NJ 07660-2112
Samsung Electronics Canada Inc.
55 Standish Court Mississauga, Ontario L5R 4B2
Call Center hours of operation: Mon-Sun, 9:00 AM -12 AM EST.
To register this product, visit: www.samsung.com/register.

Step 1: Install the Batteries into the Remote

To install batteries into your remote control, follow these steps:

- Lift the cover on the back of the remote upward as shown in the figure to the right.
- Install two AAA batteries.
Make sure to match the + and - ends of the batteries to the diagram in the battery compartment.
- Replace the cover.

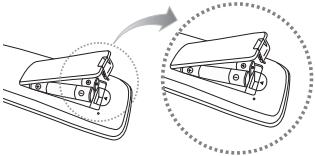

Step 2: Connect Power and Antenna or Cable

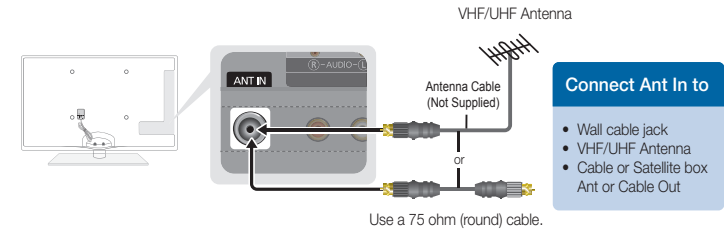

Step 3: Run Plug & Play

When you turn on your TV for the first time, it automatically launches the Plug & Play function. With Plug & Play, you can select the On Screen Display language, set the clock mode, and launch the TV's channel memorizing process. It also displays connection instructions similar to those in this guide. To navigate while Plug & Play is running, press the Up, Down, Left or Right arrow buttons on your remote. To make a selection, press the **ENTER** button. To skip a screen, press the **MENU** button. To turn on your TV, press the **POWER** button on the remote or on the TV. To run Plug & Play, follow these steps:

- Using your remote control, select the language for the On Screen Display (OSD), and then press the **ENTER** button.
- Select **Home Use**, and then press the **ENTER** button. If you select **Store Demo**, the TV will reset your picture and audio settings every 30 minutes.
- Select **Antenna Source**. If **Antenna Source** is **Air**, **Cable** or **Auto**, you must select your cable system type. After selecting source, select **Search**; then press the **ENTER** button on your remote.
- The TV memorizes the available channels. This process can take up to 45 minutes.

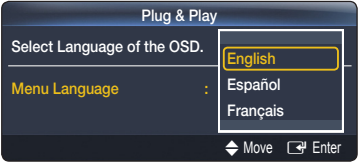

Step 4: Connect External Devices

Connecting an AV device (DVD/Blu-ray player, cable/satellite box, etc.)

Use one of the connections below to connect your TV to an external A/V device. We recommend using HDMI for the highest picture quality.

- When connecting to AV IN 1 on the back of your TV, attach the video cable (yellow) to the green jack next to the AV IN 1 label. The jack will not match the color of the video cable (yellow).

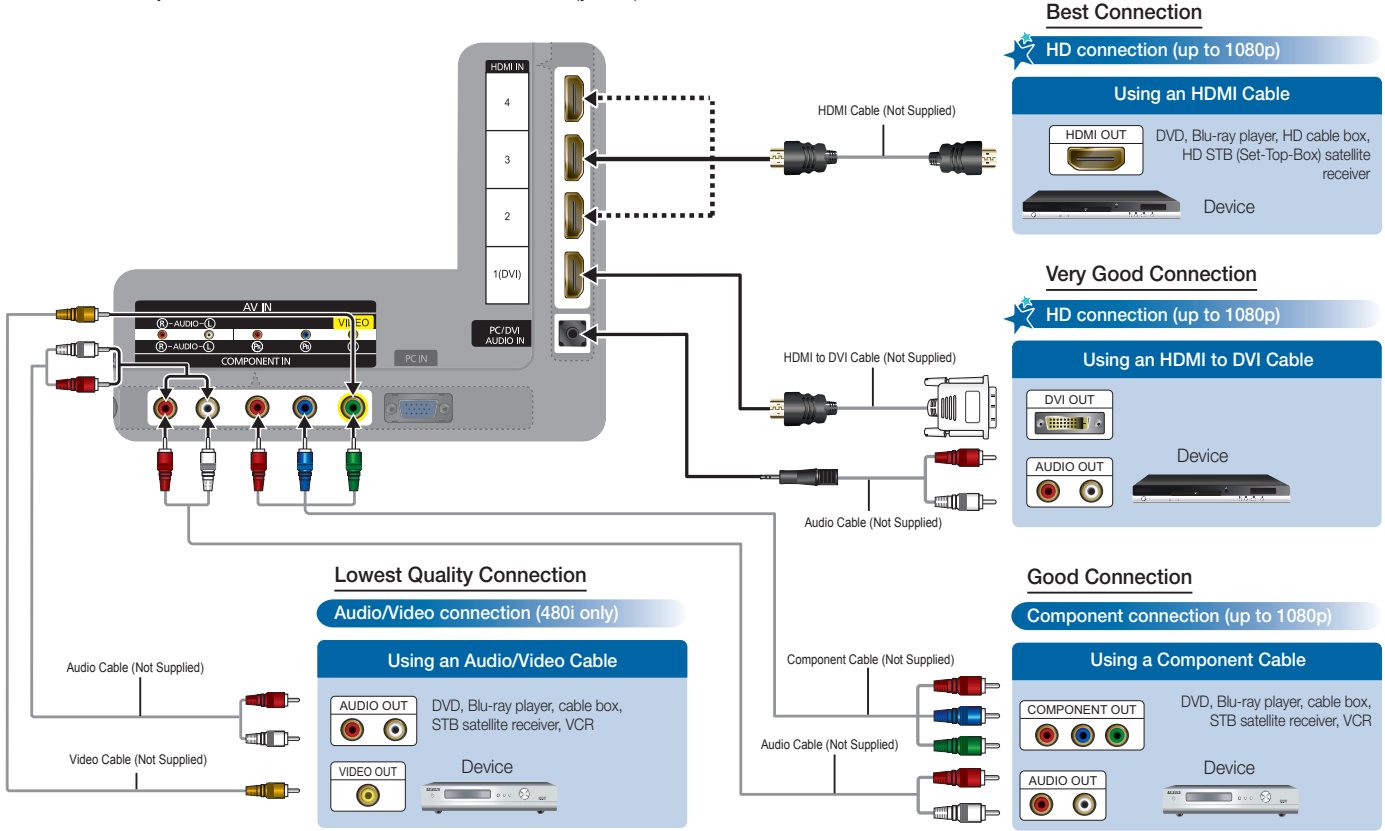

Changing the Screen Size

Your TV has several screen size options, each designed to work best with specific types of video input. If you have a cable box or satellite receiver, it may have its own set of screen sizes as well.

To change the screen size, press the **P.SIZE** button on your remote. The first time you press it, your TV displays the current setting. Thereafter, each time you press the **P.SIZE** button, you change the size of the picture on the screen.

The following sizes are available:

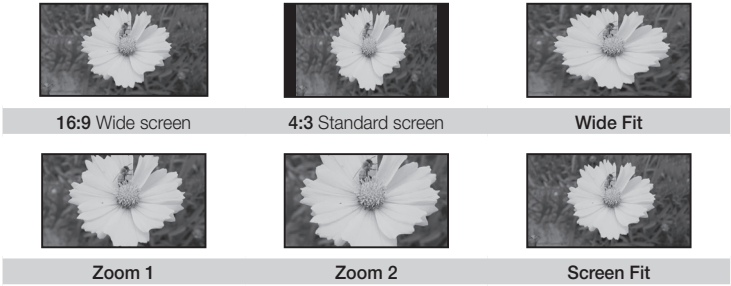

- Screen Fit:** Displays the full image without any cut-off when HDMI (720p / 1080i / 1080p) or Component (1080i / 1080p) signals are inputted.

Connecting an audio device (Home Theater, etc.)

Connect your TV to your Home Theater or other audio device to enjoy enhanced Sound quality.

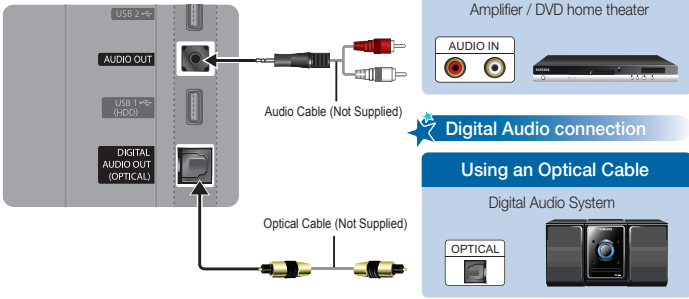

Connecting a PC

Connect your TV to a PC to use it as a Monitor.

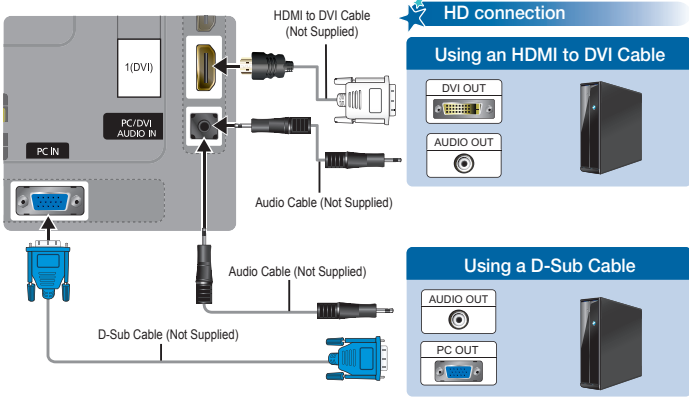

Changing the Picture Mode

Your TV has four preset **Picture** modes with factory adjusted settings, each designed to give you an excellent picture under specific conditions.

To change the **Picture** mode, press the **P.MODE** button on your remote. The first time you press it, your TV displays the current setting. Thereafter, each time you press the **P.MODE** button, you change the mode of the picture on the screen.

The **Picture** Modes are listed and described in the table below:

Mode	Description
Dynamic	Brightens picture. For a vibrant, enhanced image in brightly lit or sunny room.
Standard	For a bright, detailed picture in a normally lit room.
Natural	For a comfortable, easy-on-the-eyes picture in a normally lit room.
Movie	For a studio quality cinema picture in a dimly lit or dark room.

To change the **Picture Mode**, follow these steps:

- With the TV on, Press the **MENU** button on your remote, then select **Picture**.
- Select **Mode**, then Press the **ENTER** button.
- On the **Mode** menu in **Picture**, use the **▼** or **▲** on your remote to select the picture mode you want.
- Press the **ENTER** button to finish the change.

Step 5: Remote Control

Remote Control Buttons and Functions

This is a special remote control for the visually impaired and has Braille points on the Power, Channel and Volume buttons.

Turns the TV on and off.

Displays and selects the available video sources.

Press to directly access channels.

Press to select additional channels (digital) being broadcasted by the same station. For example, to select channel "54-3", press "54", then press "-" and "3".

Adjusts the volume.

Brings up the OSD.

Displays **Media Play**.

Quickly select frequently used functions.

Returns to the previous menu.

These buttons are for the **Channel list**, **Media Play** menu, etc.

Use these buttons in **Media Play** and **Anynet+ (HDMI-CEC)** modes.
(): Controls recording for Samsung recorders that have the Anynet+ feature)

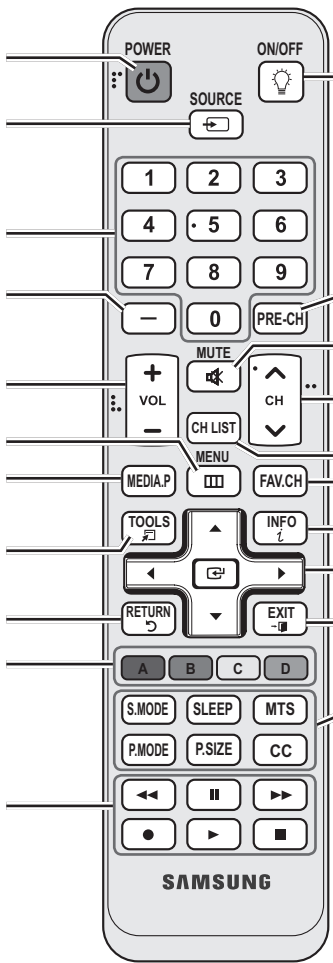

Turns the remote control light on or off. When on, the buttons become illuminated for a moment when pressed. (Using the remote control with this button set to ON will reduce the battery usage time.)

Returns to the previous channel.

Cuts off the sound temporarily.

Changes channels.

Displays the channel list on the screen.

Displays Favorite Channel Lists on the screen.

Displays information on the TV screen.

Selects the on-screen menu items and changes the values seen on the menu.

Exits the menu.

S.MODE: Press to select the sound mode.
SLEEP: Use to set the sleep timer function.
MTS: Press to choose stereo, mono or Separate Audio Program (SAP broadcast).
P.MODE: Press to select the picture mode.
P.SIZE: Selects the picture size.
CC: Controls the caption decoder.

Changing Channels and Adjusting the Volume

Adjust the volume by pressing the Volume button on the remote.

Change the channels by pressing the Channel button on the remote.

If your TV is attached to a cable or satellite box, change the channel using the box's remote.

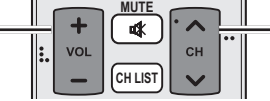

You can also change the channels by pressing the **CH** button on the front panel of your TV and adjust the volume by pressing the **-VOL+** button.

Selecting a Source

To watch a movie on your Blu-ray player or watch your favorite TV show, you must select the correct source. A source is a device, such as a Blu-ray/DVD player, a cable/satellite box, antenna or a cable TV input. Sources can be connected to your TV through the HDMI, DVI, Component, Composite, or D-sub connections, or through the Antenna or Cable In connections.

To view the signal from a source connected to the HDMI, DVI, Component, Composite, or D-sub jack, press the **SOURCE** button on your remote. Each time you press the **SOURCE** button, you change to a different source.

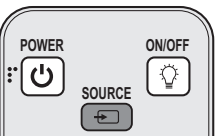

Viewing the On Screen Menus

To view the On Screen Menus, follow these steps:

- With the power on, press the **MENU** button on your remote. The main menu appears. The menu's left side has the following menu options: **Picture**, **Sound**, **Channel**, **Setup**, **Input**, **Application** and **Support**.
- Press the **▲** or **▼** button on your remote to select a menu option, and then press the **ENTER** button.
- When done using the menu, press the **EXIT** button on your remote to exit.



Step 6: The Media Play Features

The Media Play feature lets you connect to your PC through your home network and stream PC audio and video files to your HDTV using your remote. To use IPTV or Samsung PC Share Manager, you must connect your TV to your network. You can attach the TV to your network in two ways, by cable, using CAT 5 cable, or wirelessly, using a Samsung Wireless LAN Adapter. Instructions for both connection methods are below.

Network Connection - Wired

There are two main ways to connect your TV to your network using cable, depending on your network setup. They are illustrated below:

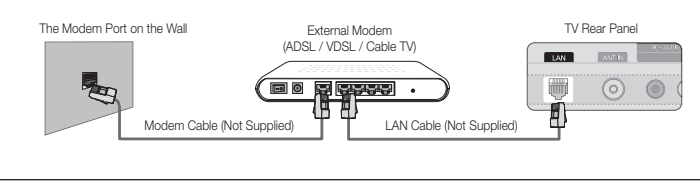

The Modem Port on the Wall External Modem (ADSL / VDSL / Cable TV) TV Rear Panel

Modem Cable (Not Supplied) LAN Cable (Not Supplied)

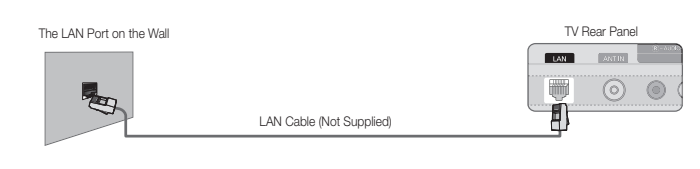

The LAN Port on the Wall TV Rear Panel

LAN Cable (Not Supplied)

Configuring the Network Connection - Wired

Most home networks use the Dynamic Host Configuration Protocol (DHCP) to configure network connections. Home networks that support DHCP automatically provide the IP address, subnet mask, gateway, and DNS values your TV needs to access the Internet so you don't have to enter them manually.

To configure your network connection for a network that uses DHCP, follow these steps:

- Connect your TV to your network as shown in one of the illustrations above.
- Turn on your TV, press the **MENU** button on your remote, and then select **Setup** → **Network**.
- Set the **Network Type** to **Wired** if it is not already set to **Wired**.
- Select **Network Setup**. The **Network Setup** screen appears.
- On the **Network Setup** menu, set **Internet Protocol Setup** and **DNS** to **Auto**. **Auto** acquires and enters the necessary internet values automatically.
- Select **Network Test** to check Internet connectivity.

Some networks are Static IP networks. If your network is a Static IP network, you can not use DHCP to configure the network connection. Instead, you must enter the **IP Address**, **Subnet Mask**, **Gateway**, and **DNS Server** manually. For instructions explaining how to configure a Static IP network, see your user's manual.

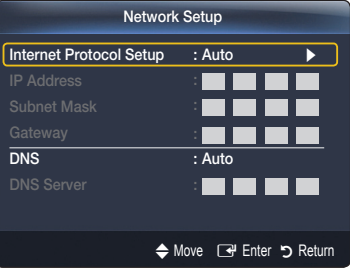

Network Connection - Wireless

You can connect your TV to your LAN through a standard wireless router or modem. To connect wirelessly, you must first attach a "Samsung Wireless LAN Adapter" (WIS09ABGN, WIS09ABGN2, WIS10ABGN - sold separately) to either the **USB 1 (HDD)** or **USB 2** port on the back of your TV. See the illustration below.

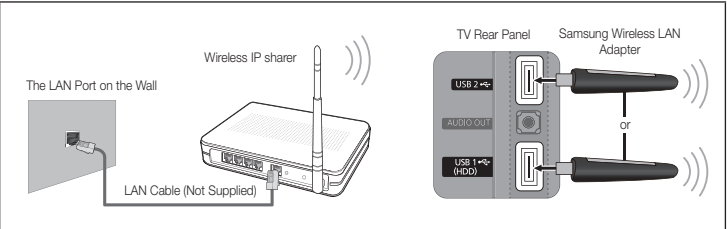

Samsung's Wireless LAN adapter is sold separately and is offered by select retailers, Ecommerce sites and Samsungparts.com. Samsung's Wireless LAN adapter supports the IEEE 802.11A/B/G and N communication protocols. Samsung recommends using IEEE 802.11N. When you play the video over a IEEE 802.11B/G connection, the video may not play smoothly.

Most wireless network systems incorporate a security system that requires devices that access the network through an access point or AP (typically a wireless IP Sharer) to transmit an encrypted security code called an access key.

If Pure High-throughput (Greenfield) 802.11N mode is selected and the Encryption type is set to WEP, TKIP or TKIPAES (WPS2Mixed) for your AP, Samsung TVs will not support a connection in compliance with new Wi-Fi certification specifications.

Configuring the Network Connection - Wireless

The instructions below are for networks that use the Dynamic Host Configuration Protocol (DHCP) to configure network connections automatically. If your have a Static IP network, see your user's manual for configuration instructions.

To configure your network connection for a network that uses DHCP, follow these steps:

- Connect your TV to your network as shown in the illustrations above.
- Turn on your TV, press the **MENU** button on your remote, and the select **Setup** → **Network**.
- Set the **Network Type** to **Wireless** if it is not already set to **Wireless**.
- Select **Network Setup**. The **Network Setup** screen appears.
- On the **Network Setup** menu, select an AP(Access Point) and ad hoc network. if you have selected network with a security key, the **Security Key** screen appears.
- Enter the security key using the numbers on the remote, and then press the Blue button on your remote.
- On the **Network Setup** menu, set **Internet Protocol Setup** and **DNS** to **Auto**. The **Auto** acquires and enters the necessary internet values automatically.
- Select **Network Test** to check internet connectivity.

For more information, see your user's manual.

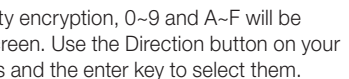
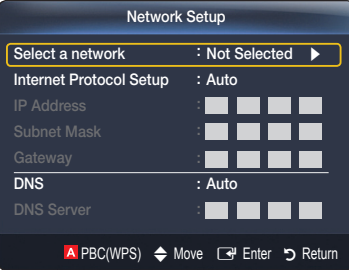

Connecting a USB Device for Media Play

You can enjoy photo, music, and movie files stored on a USB device by connecting it to the TV and using the **Media Play** feature. For Media Play operating instructions, please see your Owner's Manual.





BN68-02957A-01