



Contact SAMSUNG WORLDWIDE

If you have any questions or comments relating to Samsung products, please contact the SAMSUNG customer care center.

Country	Customer Care Center ☎	Web Site	Address
CANADA	1-800-SAMSUNG (726-7864)	www.samsung.com	Samsung Electronics Canada Inc., Customer Service 55 Standish Court Mississauga, Ontario L5R 4B2 Canada
U.S.A	1-800-SAMSUNG (726-7864)	www.samsung.com	Samsung Electronics America, Inc. 85 Challenger Road Ridgefield Park, NJ 07660-2112



SERIES **6**
6400
6450

LED TV

user manual



imagine the possibilities

Thank you for purchasing this Samsung product.
To receive more complete service, please register
your product at

www.samsung.com/register

Model _____ Serial No. _____



Figures and illustrations in this User Manual are provided for reference only and may differ from actual product appearance. Product design and specifications may be changed without notice.

Important Warranty Information Regarding Television Format Viewing

 See the warranty card for more information on warranty terms.

Wide screen format LED Displays (16:9, the aspect ratio of the screen width to height) are primarily designed to view wide screen format full-motion video. The images displayed on them should primarily be in the wide screen 16:9 ratio format, or expanded to fill the screen if your model offers this feature and the images are constantly moving. Displaying stationary graphics and images on screen, such as the dark sidebars on non-expanded standard format television video and programming, should be limited to no more than 5% of the total television viewing per week.

Additionally, viewing other stationary images and text such as stock market reports, video game displays, station logos, web sites or computer graphics and patterns, should be limited as described above for all televisions. Displaying stationary images that exceed the above guidelines can cause uneven aging of LED Displays that leave subtle, but permanent burned-in ghost images in the LED picture. To avoid this, vary the programming and images, and primarily display full screen moving images, not stationary patterns or dark bars. On LED models that offer picture sizing features, use these controls to view different formats as a full screen picture.

Be careful about the television formats you select and the length of time you view them. Uneven LED aging as a result of format selection and use, as well as burned in images, are not covered by your Samsung limited warranty.

- **SAMSUNG ELECTRONICS NORTH AMERICAN LIMITED WARRANTY STATEMENT**

Subject to the requirements, conditions, exclusions and limitations of the original Limited Warranty supplied with Samsung Electronics (SAMSUNG) products, and the requirements, conditions, exclusions and limitations contained herein, SAMSUNG will additionally provide Warranty Repair Service in the United States on SAMSUNG products purchased in Canada, and in Canada on SAMSUNG products purchased in the United States, for the warranty period originally specified, and to the Original Purchaser only.

The above described warranty repairs must be performed by a SAMSUNG Authorized Service Center. Along with this Statement, the Original Limited Warranty Statement and a dated Bill of Sale as Proof of Purchase must be presented to the Service Center. Transportation to and from the Service Center is the responsibility of the purchaser. Conditions covered are limited only to manufacturing defects in material or workmanship, and only those encountered in normal use of the product.

Excluded, but not limited to, are any originally specified provisions for, in-home or on-site services, minimum or maximum repair times, exchanges or replacements, accessories, options, upgrades, or consumables.

For the location of a SAMSUNG Authorized Service Center, please call toll-free:

- In the United States : 1-800-SAMSUNG (1-800-726-7864)
- In Canada : 1-800-SAMSUNG

Still image warning

Avoid displaying still images (such as jpeg picture files), still image elements (such as TV channel logos, stock or news bars at the screen bottom etc.), or programs in panorama or 4:3 image format on the screen. Constantly displaying still pictures can cause image burn-in on the LED screen, which will affect image quality. To reduce risk of this effect, please follow the recommendations below:

- Avoid displaying the same TV channel for long periods.
- Always try to display any image in full screen. Use the TV set's picture format menu for the best possible match.
- Reduce brightness and contrast to avoid the appearance of after-images.
- Use all TV features designed to reduce image retention and screen burn. Refer to the e-Manual for details.

Accessories

 Please make sure the following items are included with your TV. If any items are missing, contact your dealer.

 The items' colors and shapes may vary depending on the model.

 Check that there are no accessories hidden behind or under packing materials when you open the box.

- Remote Control (AA59-00442A) & Batteries (AAA x 2)
- Owner's Instructions
- Power Cord
- Cleaning Cloth
- Warranty Card / Safety Guide

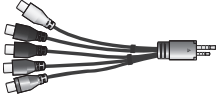

AV/Component Adapter
(BN39-01154W)



AV Adapter
(BN39-01154H)



Holder-Ring (4EA)
(BN61-07295A)



Holder-Wire stand
(BN61-05491A)



3D Active Glasses
(LED 6450 Series Only)
(BN96-18927A)

Input Cables (Sold Separately)

To purchase the RS232 cable, contact www.SamsungParts.com.



RS232 (AA39-00311A)



Audio



HDMI



HDMI-DVI



Component



Composite (AV)



Coaxial (RF)

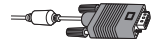

VGA

QWERTY Remote (Sold Separately)

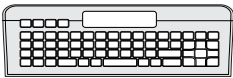

QWERTY Remote

Viewing the Control Panel

- The product color and shape may vary depending on the model.
- There are control buttons in rear of TV. When you touch the button, control icons appears.
- Any object (an electric wire, etc.) near the control panel may cause unintended activation of the OSD.

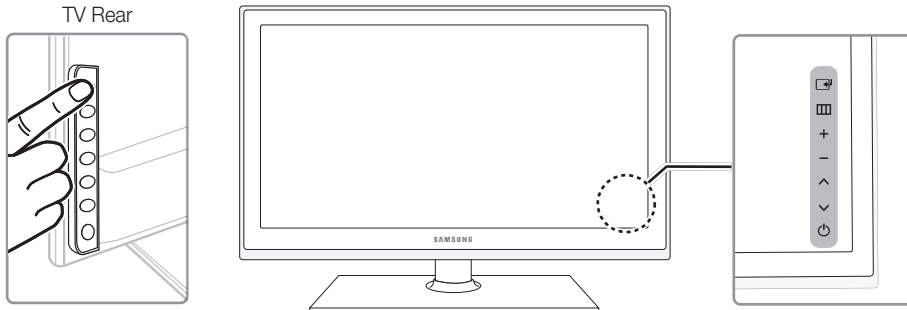

Remote control sensor	Aim the remote control towards this spot on the TV.
Power Indicator	Blinks and turns off when the power is on and lights up in standby mode.
(Source)	Toggles between all the available input sources. In the on-screen menu, use this button as you would use the ENTER button on the remote control.
MENU	Displays an on-screen menu, the OSD (on screen display) of your TV's features.
(Volume)	Adjusts the volume. In the OSD, use the + - buttons as you would use the ◀ and ▶ buttons on the remote control.
(Channel)	Changes the channels. In the OSD, use the ▲ ▼ buttons as you would use the ▼ and ▲ buttons on the remote control.
(Power)	Turns the TV on or off.

Standby mode

Your TV enters Standby mode when you turn it off and continues to consume a small amount of electric power. To be safe and to decrease power consumption, do not leave your TV in standby mode for long periods of time (when you are away on a holiday, for example). It is best to unplug the power cord.

Install the Stand

See separate guide for installing the stand.

A 1 EA

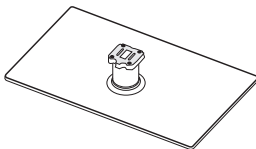

Stand (1EA)

B 1 EA

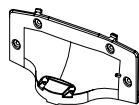

Guide Stand (1EA)

C x4 (M4 X L12)

D x4 (M4 X L8)

Screws (8EA)

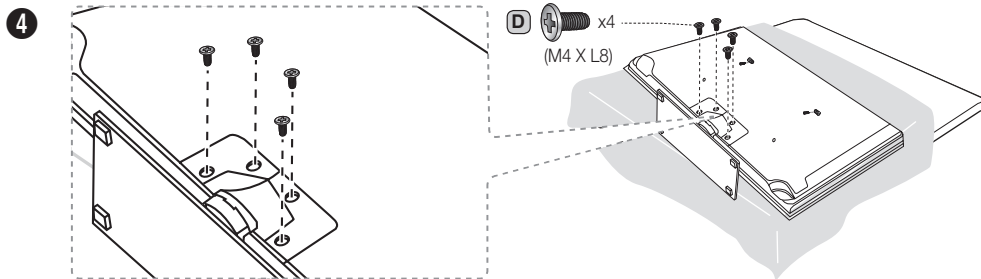
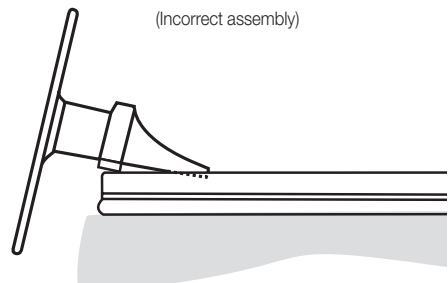
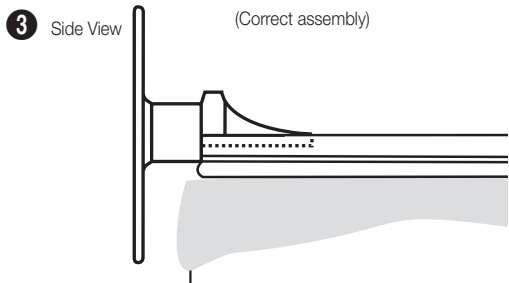
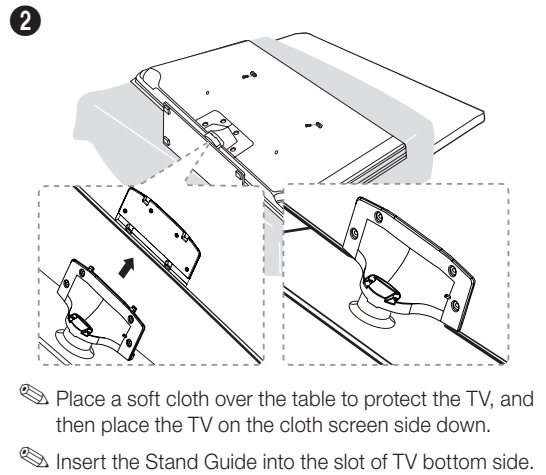
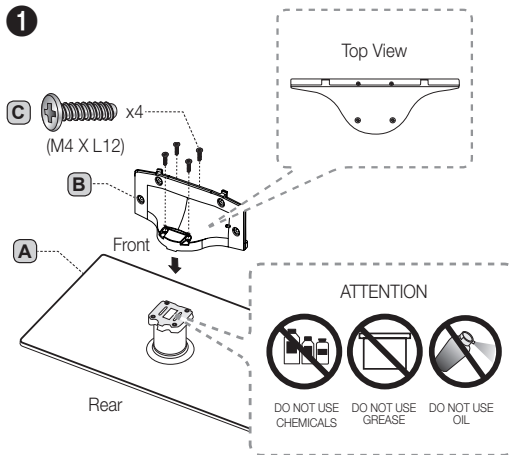

NOTE

- Make sure to distinguish between the front and back of each component when assembling them.
- Make sure that at least two persons lift and move the TV.
- Stand the product up and fasten the screws. If you fasten the screws with the TV placed down, it may lean to one side.

Assembling the Holder-Wire stand

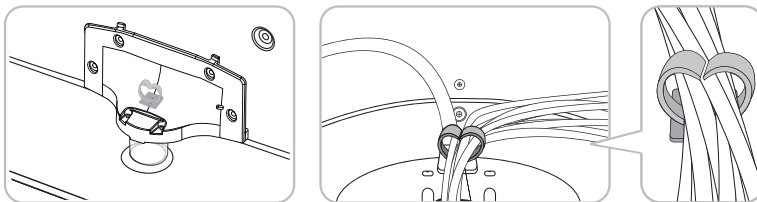

Installing the Wall Mount

Preparing before installing Wall-Mount

To install a wall-mount from another manufacturer, use the Holder-Ring.

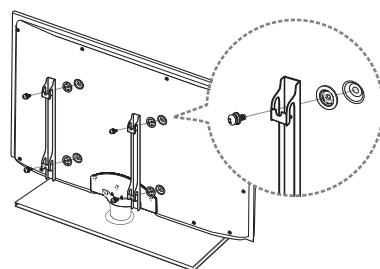

Installing the Wall Mount Kit

The wall mount kit (sold separately) allows you to mount the TV on the wall.

For detailed information on installing the wall mount, see the instructions provided with the wall mount. Contact a technician for assistance when installing the wall mount bracket. Samsung Electronics is not responsible for any damage to the product or injury to yourself or others if you elect to install the TV on your own.

Wall Mount Kit Specifications (VESA)

Install your wall mount on a solid wall perpendicular to the floor. Before attaching the wall mount to surfaces other than plaster board, please contact your nearest dealer for additional information. If you install the TV on a ceiling or slanted wall, it may fall and result in severe personal injury.

NOTE

- Standard dimensions for wall mount kits are shown in the table below.
- Samsung wall mount kits contain, a detailed installation manual and all parts necessary for assembly are provided.
- Do not use screws that do not comply with the VESA standard screw specifications.
- Do not use screws that are longer than the standard length or do not comply with the VESA standard screw specifications. Screws that are too long may cause damage to the inside of the TV set.
- For wall mounts that do not comply with the VESA standard screw specifications, the length of the screws may differ depending on the wall mount specifications.
- Do not fasten the screws too firmly. This may damage the product or cause the product to fall, leading to personal injury. Samsung is not liable for these kinds of accidents.
- Samsung is not liable for product damage or personal injury when a non-VESA or non-specified wall mount is used or the consumer fails to follow the product installation instructions.
- Our 55" model do not comply with VESA Specifications. Therefore, you should use our dedicated wall mount kit for this model.
- Do not mount the TV at more than a 15 degree tilt.
- Always have two people mount the TV on a wall.

Product Family	TV size in inches	VESA screw hole specs (A * B) in millimeters	Standard Screw	Quantity
LED-TV	32~40	200 X 200	M8	4
	46~55	400 X 400		
	60~65	600 X 400		

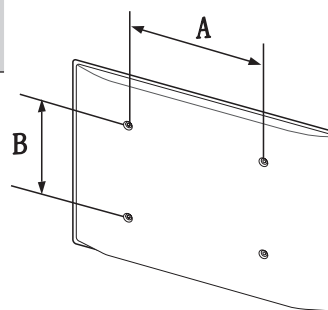

Do not install your Wall Mount Kit while your TV is turned on. It may result in personal injury due to electric shock.

Remote Control Buttons

 This remote control has Braille points on the Power, Channel, and Volume buttons and can be used by visually impaired persons.

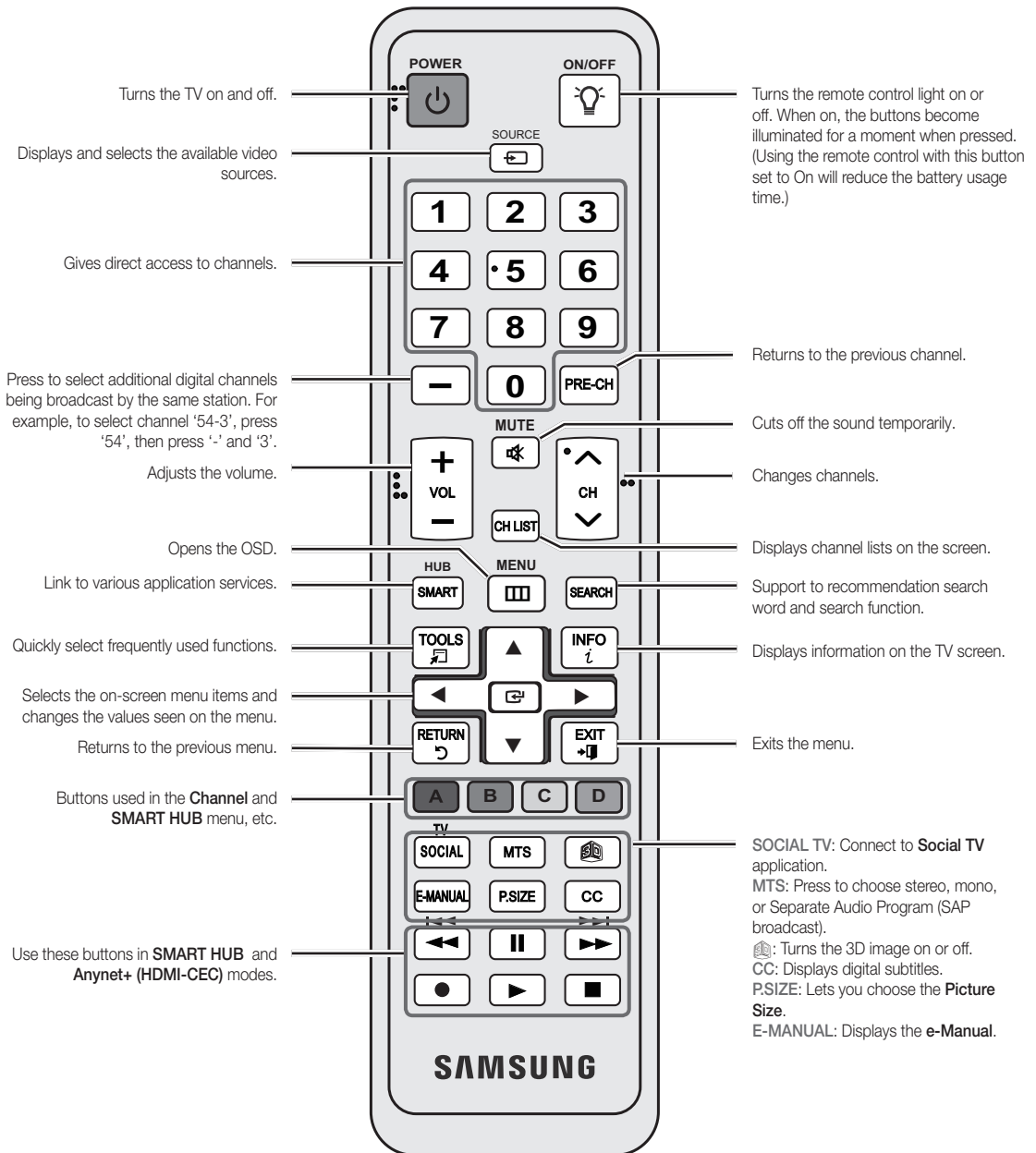

Installing batteries (Battery size: AAA)

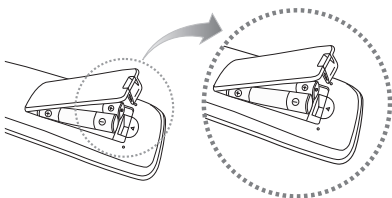

NOTE

- Use the remote control within 23 feet from the TV.
- Bright light may affect the performance of the remote control. Avoid using when near special fluorescent lights or neon signs.
- The color and shape may vary depending on the model.

How to Navigate Menus

Before using the TV, follow the steps below to learn how to navigate the menu and select and adjust different functions.

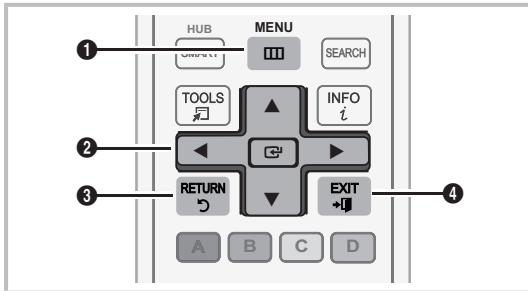

- 1 **MENU** button: Displays the main on-screen menu.
- 2 **ENTER** / **Direction** button: Move the cursor and select an item. Confirm the setting.
- 3 **RETURN** button: Returns to the previous menu.
- 4 **EXIT** button: Exits the on-screen menu.

How to Operate the OSD (On Screen Display)

The access steps may differ depending on the selected menu.

1	MENU	The main menu options appear on the screen: Picture, Sound, Channel, Network, System, Support.
2	▲ / ▼	Select an icon or option with the ▲ or ▼ button.
3	ENTER	Press ENTER to access the sub-menus.
4	▲ / ▼	Select the desired submenu with the ▲ or ▼ button.
5	◀ / ▶	Adjust the value of an item with the ◀ or ▶ button. The adjustment in the OSD may differ depending on the selected menu.
6	ENTER	Press ENTER to confirm the selection.
7	EXIT	Press EXIT .

For the best cable connections to this product, be sure to use cables with a maximum thickness of 0.55 inches (14mm).

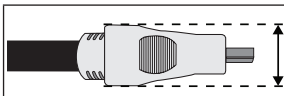

- Maximum thickness - 0.55 inches (14mm)

Connecting the power cord and an antenna or cable connection

Connecting the power cord and an antenna or cable connection

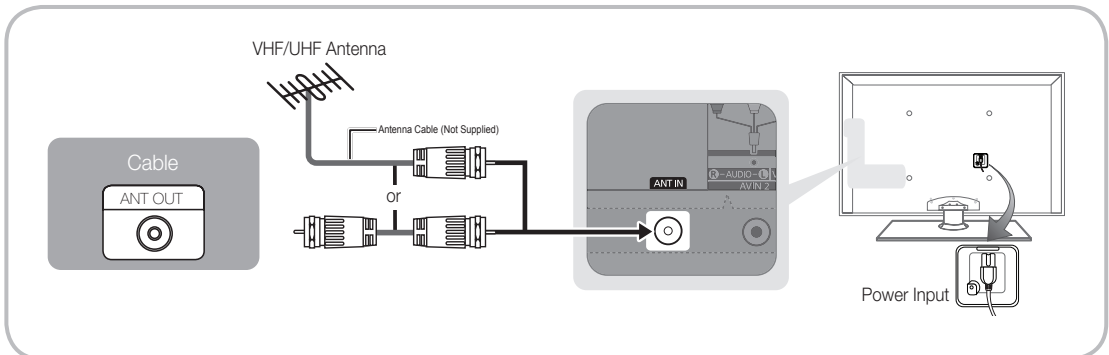

When the TV is initially powered on, basic settings proceed automatically.



















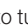
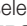



Plug & Play (Initial Setup)

When you turn the TV on for the first time, a sequence of on-screen prompts will assist in configuring basic settings. To turn on the TV, press the **POWER**  button.



 **Plug & Play** is available only when the **Source** is set to TV.

 To return to the previous step in the **Plug & Play** sequence, select **Previous**, and then press **ENTER** .

 Before turning on the TV, make you have connected the TV to an antenna or cable connection (p. 8).

1	Selecting the OSD Language	Press the ▲ or ▼ button to select a language. Press ENTER  twice when done.	
2	Setting the Network	Set up your network connection. Press the ENTER  button to start. If you do not know your network set up information or want to set to it later, select Skip . We suggest you skip network connection setup now and refer to "Network menu" in the e-Manual for set up requirements and instructions, and the Network Connection section of this manual (Page 15). You can set up the network connection later using the Network menu.	
3	Selecting the usage mode	Press the ▲ or ▼ button to select Home Use , and then press the ENTER  button twice. Select the Home Use mode. Store Demo mode is for retail environments.	
4	Setting the Clock Mode	<p>Press the ▲ or ▼ button to select Auto or Manual, and then press ENTER  twice.</p> <p> If you selected Auto, you'll go to the Time Zone and DST screen. Select Time Zone or DST, and then press ENTER . On the Time Zone screen, use the ▲ or ▼ button to select your zone, and then press ENTER . On the DST screen, press, ENTER , then select whether to turn DST (Daylight Savings Time) on or off. When done, press ENTER .</p> <p> If you selected Manual, you'll go to the Date and Time screen. Select Date or Time, and then press ENTER . Then, use the number buttons or the ▲ or ▼ button to set the date or time. Use the ◀ or ▶ button to move between entry fields. When done setting the Date and Time, select Next, and then press ENTER .</p>	
5	Selecting search options for auto tuning	<p>Press the ▲ or ▼ button to select Air or Cable, and then press ENTER . A check appears on your selection. Select Next, and then press the ENTER  button. You can check both if you have both connected.</p> <p> If you selected Cable, you'll go to the Cable System screen. Use the ▲ or ▼ button to select Digital or Analog, and then press, ENTER . Use the ▲ or ▼ button to select the correct cable signal format - STD, HRC, or IRC - and then press ENTER . Most cable systems use STD. Select the correct cable signal format for both the Digital and Analog systems.</p> <p> When done, select Next, and the press ENTER .</p>	
6	Selecting and memorizing channels	<p>The channel search will start automatically. This can take up to 30 minutes. For more information, refer to Channel → Auto Program in the e-Manual.</p> <p> Press the ENTER  button at any time to interrupt the memorization process.</p>	
7	Enjoy your TV.	<p>If you want to watch a broadcast program, select Close.</p> <p>If you want to enjoy Smart Hub, select Smart Hub. Smart Hub will start. For more detailed information, refer to "Smart Hub" in the e-Manual.</p>	

If You Want to Rerun Plug & Play...

 **MENU** → **System** → **Plug & Play** → **ENTER** 

NOTE

- To change the TV's setting from **Store Demo** to **Home Use** when not in Plug & Play, press the volume button on the TV. When you see the volume bar on the screen, press and hold the **MENU** button on the TV for 5 sec.

Connecting to an AV Device

Using an HDMI or an HDMI to DVI Cable: HD connection (up to 1080p)

We recommend using the HDMI connection for the best quality HD picture.

Available devices: DVD player, Blu-ray player, HD cable box, HD STB (Set-Top-Box) satellite receiver

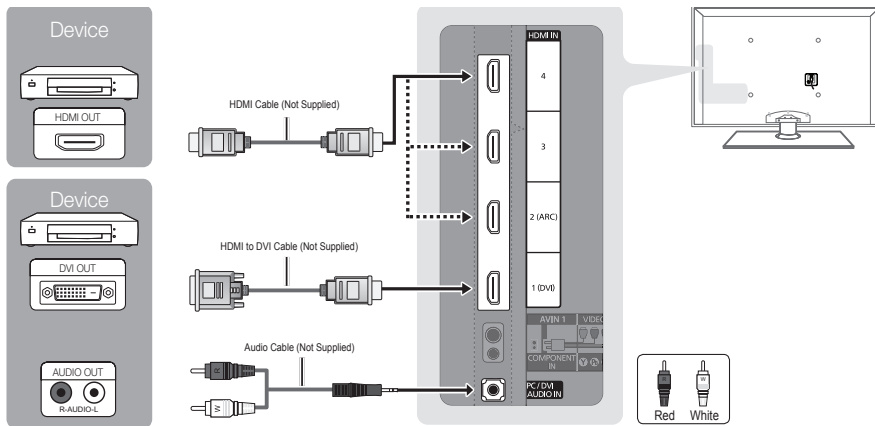

HDMI IN 1 (DVI), 2 (ARC), 3, 4 / PC/DVI AUDIO IN

- For better picture and audio quality, connect to a digital device using an HDMI cable.
- An HDMI cable supports digital video and audio signals, and does not require an audio cable.
 - To connect the TV to a digital device that does not support HDMI output, use an HDMI/DVI and audio cables.
- The picture may not display normally (if at all) or the audio may not work if you connect an external device that uses an older version of HDMI mode is connected to the TV. If such a problem occurs, ask the manufacturer of the external device about the HDMI version and, if out of date, request an upgrade.
- Be sure to use an HDMI cable with a thickness of 14 mm or less.
- Be sure to purchase a certified HDMI cable. Otherwise, the picture may not display or a connection error may occur.
- We recommend using a basic high-speed HDMI cable or an HDMI cable that is Ethernet compatible. Note that this product does not support the Ethernet function via HDMI.
- This product supports the 3D and ARC (Audio Return Channel) functions via an HDMI cable. Note that the ARC function is supported by the **HDMI IN 2 (ARC)** port only.
- The ARC function allows digital audio to output via the **HDMI IN 2 (ARC)** port. It can be enabled only when the TV is connected to an audio receiver that supports the ARC function.

Using a Component (up to 1080p) or an Audio/Video (480i only) Cable

Available devices: DVD player, Blu-ray player, cable box, STB satellite receiver, VCR

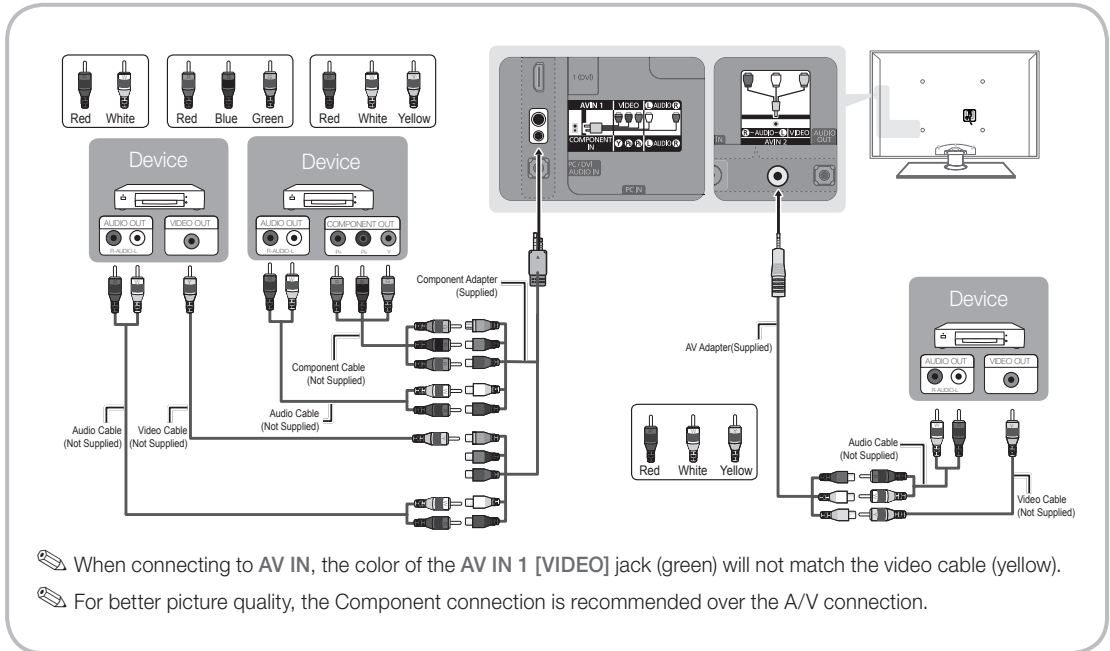

Using an EX-Link Cable Connection

Available Devices: External devices that support EX-Link.

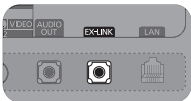

EX-LINK: Connector for service only.

Connecting to an Audio Device

Using an Optical (Digital) or an Audio (Analog) Cable Connection

Available devices: Digital Audio System, Amplifier, DVD home theater

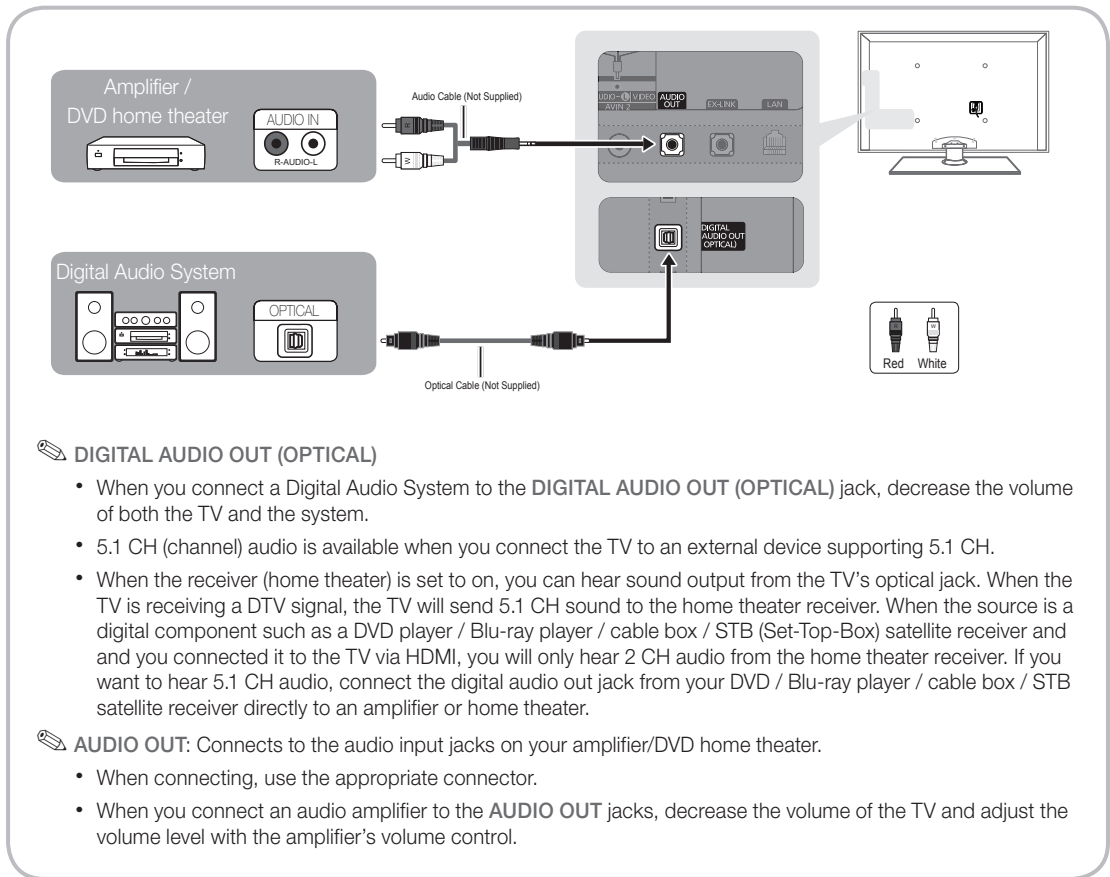

Connecting to a PC

Using an HDMI cable or an HDMI to DVI cable or a D-sub cable

Your PC may not support an HDMI connection.

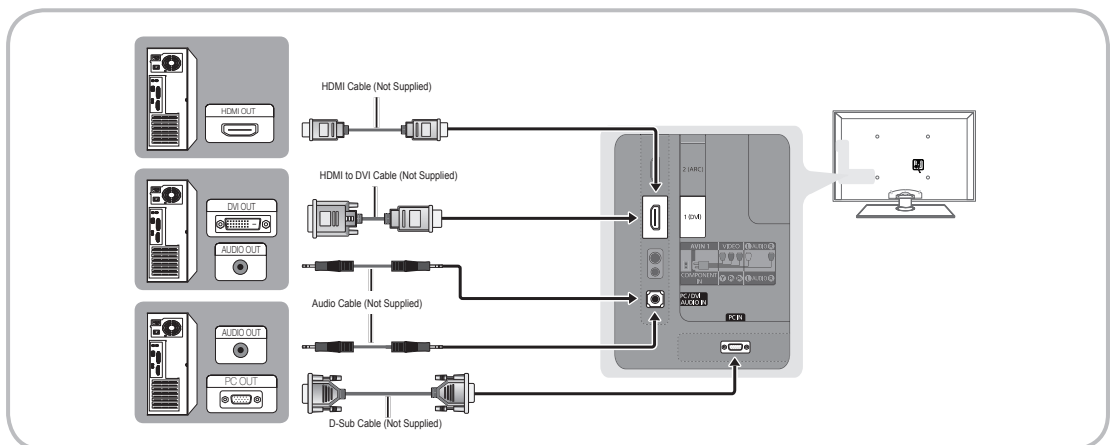

PC Display Modes (D-Sub and an HDMI to DVI Input)

Optimal PC resolution is 1920 X 1080 @ 60 Hz. You can also select one of the standard resolutions listed in the Resolution column. The TV will automatically adjust to the resolution you choose.

Mode	Resolution	Horizontal Frequency (KHz)	Vertical Frequency (Hz)	Pixel Clock Frequency (MHz)	Sync Polarity (H / V)
IBM	640 x 350	31.469	70.086	25.175	+/-
	720 x 400	31.469	70.087	28.322	-/+
MAC	640 x 480	35.000	66.667	30.240	-/-
	832 x 624	49.726	74.551	57.284	-/-
	1152 x 870	68.681	75.062	100.000	-/-
VESA DMT	640 x 480	31.469	59.940	25.175	-/-
	640 x 480	37.861	72.809	31.500	-/-
	640 x 480	37.500	75.000	31.500	-/-
	800 x 600	37.879	60.317	40.000	+/+
	800 x 600	48.077	72.188	50.000	+/+
	800 x 600	46.875	75.000	49.500	+/+
	1024 x 768	48.363	60.004	65.000	-/-
	1024 x 768	56.476	70.069	75.000	-/-
	1024 x 768	60.023	75.029	78.750	+/+
	1152 x 864	67.500	75.000	108.000	+/+
	1280 x 1024	63.981	60.020	108.000	+/+
	1280 x 1024	79.976	75.025	135.000	+/+
	1280 x 800	49.702	59.810	83.500	-/+
	1280 x 800	62.795	74.934	106.500	-/+
	1280 x 960	60.000	60.000	108.000	+/+
	1360 x 768	47.712	60.015	85.500	+/+
1440 x 900	55.935	59.887	106.500	-/+	
1440 x 900	70.635	74.984	136.750	-/+	
1680 x 1050	65.290	59.954	146.250	-/+	
VESA DMT / DTV CEA	1920 x 1080p	67.500	60.000	148.500	+/+

NOTE

- For HDMI/DVI cable connection, you must use the HDMI IN 1 (DVI) jack.
- The interlace mode is not supported.
- The set may operate abnormally if you select a non-standard video format.
- Separate and Composite modes are supported. SOG (Sync On Green) is not supported.

Changing the Input Source

Source

Use to select TV or an external input source such as a DVD player / Blu-ray player / cable box / STB satellite receiver.

1. Press the **SOURCE** button on your remote.
 2. Select a desired external input source. You can change the view mode among the **All** and **Connected** by pressing ◀ the or ▶ button.
- **TV / PC / AV1 / AV2 / COMPONENT / HDMI1/DVI / HDMI2 / HDMI3 / HDMI4 / USB / AllShare**

 You can only choose external devices that are connected to the TV. In **Source**, connected inputs are highlighted.

 In **Source**, **PC** always stays activated.





Edit Name

Edit Name lets you associate a device name to an input source. To access Edit Name, press the **TOOLS** button in **Source**. The following selections appear under Edit Name:

- **VCR / DVD / Cable STB / Satellite STB / PVR STB / AV Receiver / Game / Camcorder / PC / DVI PC / DVI Devices / TV / IPTV / Blu-ray / HD DVD / DMA**: Name the device connected to the input jacks to make your input source selection easier.

 If you have connected a PC to the **HDMI IN 1 (DVI)** port with an HDMI cable, select **PC** under **Edit Name** to enter a device name.

 If you have connected a PC to the **HDMI IN 1 (DVI)** port with an HDMI to DVI cable, select **DVI PC** under **Edit Name** to enter a device name.

 If you connected an AV device to the **HDMI IN 1 (DVI)** port with an HDMI to DVI cable, select **DVI Devices** under **Edit Name** to enter a device name.

Edit Favorites

In **Source**, press the **TOOLS** button to select **Edit Favorites**. You can set an external input source as a **Favorites**.

Information

You can see detailed information about the selected external device.

Refresh

In **Source**, If the external devices are not displayed, press the **TOOLS** button to select **Refresh**, then search for the connected devices.

Wired/Wireless Network Connection

You can set up your TV so that it can access the Internet through your local area network (LAN) using a wired or wireless connection.

Network Connection - Wireless

You can connect your TV to your LAN through a standard wireless router or modem.

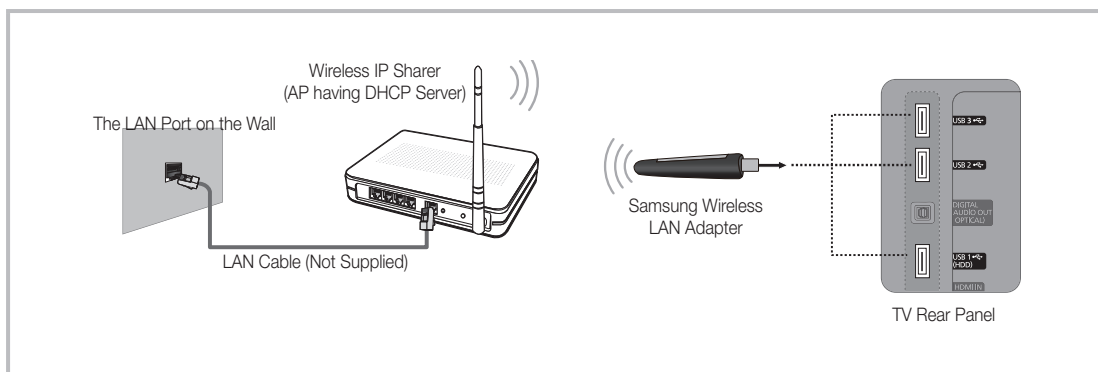

This TV supports the IEEE 802.11a/b/g and n communication protocols. Samsung recommends using IEEE 802.11n. When you play video over a IEEE 802.11b/g connection, the video may not play smoothly.





Most wireless network systems incorporate a security system that requires devices that access the network through an access point or AP (typically a wireless IP Sharer - router or modem) to transmit an encrypted security code called an access key.

If you select Pure High-throughput (Greenfield) 802.11n mode is selected and the Encryption type is set to WEP, TKIP or TKIP AES (WPS2Mixed) on your AP or wireless router, Samsung TVs will not support a connection in compliance with new Wi-Fi certification specifications.

Configuring the Network Connection - Wireless

The instructions below are for networks that use the Dynamic Host Configuration Protocol (DHCP) to configure network connections automatically. If you have a Static IP network, see your user's manual for configuration instructions.

To configure your network connection for a network that uses DHCP, follow these steps:

1. Connect your TV to your network as shown in the illustration above.
2. Turn on your TV, press the **MENU** button on your remote, and the select **Network** → **Network Settings**.
3. Select the **Wireless (General)**, press **ENTER** , and then press **ENTER**  again.
4. The Network function searches for available wireless network. When done, it displays a list of the available networks.
5. In the list of networks, press the **▲** or **▼** button to select a networks, select **Next**, and then press **ENTER** .
6. If you have selected a wireless router that has security, the Security Key screen appears. Enter the **Security key** (Security Key or PIN), select **Next**, and then press **ENTER** .

 When you enter the **Security Key** (Security Key or PIN), use **▲/▼/◀/▶** buttons on your remote to select numbers and characters.

7. The Network Connection screen appears and verifies the network connection. When the connection has been verified, the "Internet connection successful." message appears. Network set up is complete.

 For more detailed information, see "Wireless Network Connection" in the e-Manual.

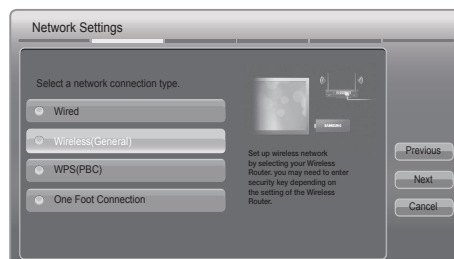

 The displayed image may differ depending on the model.

Network Connection - Wired

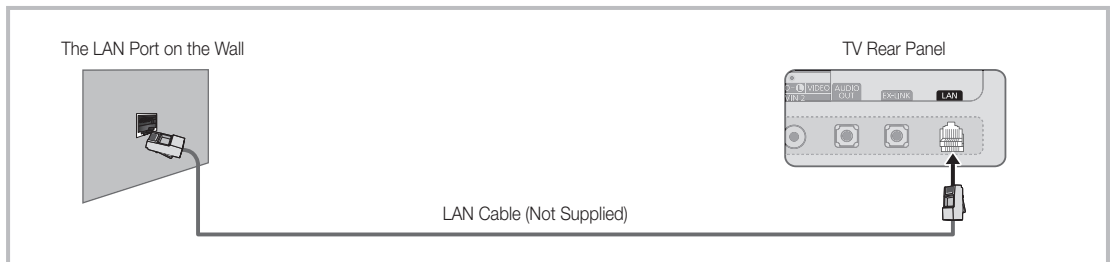
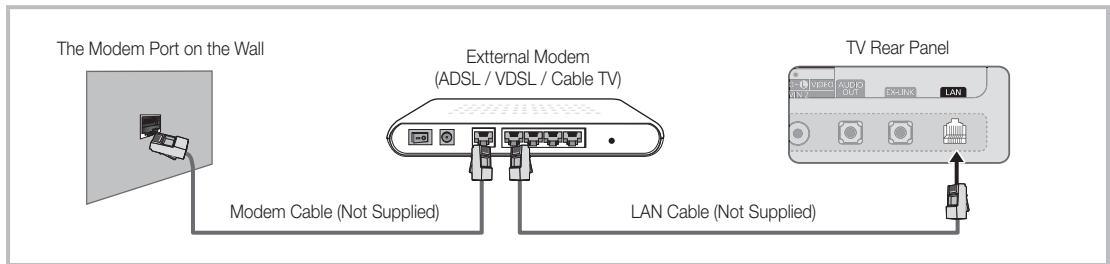

There are two main ways to connect your TV to your network using cable, depending on your network setup. They are illustrated below:



Configuring the Network Connection - Wired

Most home networks use the Dynamic Host Configuration Protocol (DHCP) to configure network connections. Home networks that support DHCP automatically provide the IP address, subnet mask, gateway, and DNS values your TV needs to access the Internet so you don't have to enter them manually.

To configure your network connection for a network that uses DHCP, follow these steps:

1. Connect your TV to your network as shown in one of the illustrations above.
2. Turn on your TV, press the **MENU** button on your remote, and then select **Network** → **Network Settings**. The **Network Settings** screen will appear.
3. Select **Wired**, press **ENTER** , and then press **ENTER**  again.
4. The Network Connection screen appears, and verifies the network connection. When the connection has been verified, the "Internet connection successful." message appears. Network set up is completed.

 If your TV cannot acquire network the connection values automatically or if you want to set the connection manually, select **IP Settings** on the network test screen. Set **Internet Protocol Setup to Manual**. You must enter the **IP Address**, **Subnet Mask**, **Gateway**, and **DNS Server** manually.

 For more detailed information, see "Wired Network Connection" in the e-Manual.

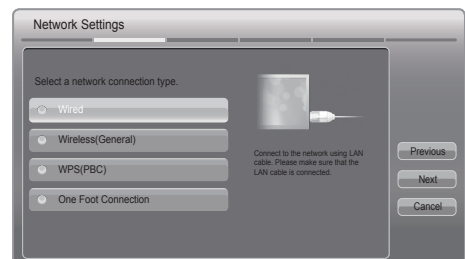

 The displayed image may differ depending on the model.

How to view the e-Manual

E-MANUAL



You can find instructions about your TV's features in the e-Manual in your TV. To use, press the **E-MANUAL** button on your remote. Move the cursor using the up/down/right/left buttons to highlight a category, then a topic, and then press the **ENTER** button. The e-Manual displays page you want to see.

You can also access it through the menu:

MENU → **Support** → **e-Manual** → **ENTER**

If you want to return to the e-Manual, press the **E-MANUAL** button on your remote.

You cannot use **Try now** function if the TV menu is not activated.

Screen Display

TV Screen: Displays the program, movie, video, etc. you are currently watching.

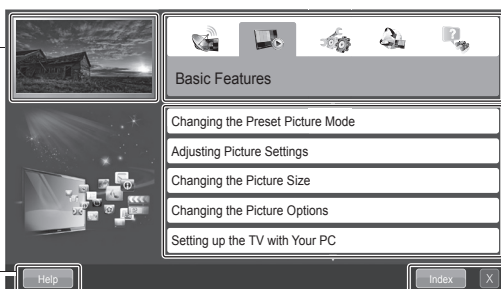

The category list. Press ◀ or ▶ button to select the category you want.

Displays the sub-menu list. Use the arrow buttons on your remote to move the cursor. Press **ENTER** button to select the sub-menu you want.

Help: Displays the e-Manual Guide or Product Guide. Press **ENTER** button.

Index: Displays index screen.
X: Exit the e-Manual.

Using the Help

Display the e-Manual Guide & the Product Guide by pressing **Help**.

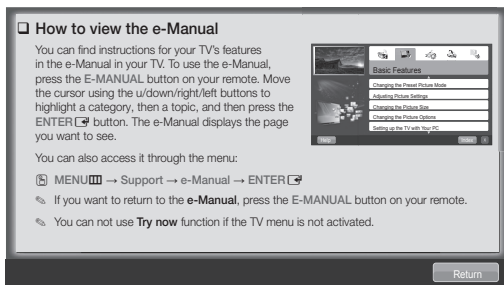

<e-Manual Guide>

The e-Manual guide appears as above.



<Product Guide>

The product guide appears as above.

How to toggle between the e-Manual and the corresponding OSD menu(s).

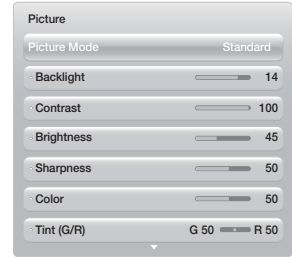
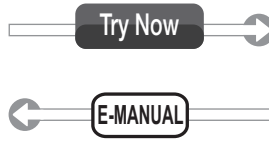
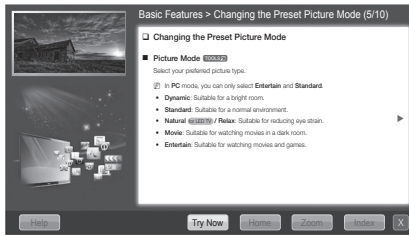

This function is not enabled in some menus.

Method 1

1. Select **Try Now**, if you want to execute the corresponding menu(s).
2. To return to the e-Manual screen, press the **E-MANUAL** button.

Method 2

1. Press the **ENTER** button when a topic is displayed. **"Do you want to execute this?"** appears. Select **Yes**, and then press the **ENTER** button. The OSD window appears.
2. To return to the **e-Manual** screen, press the **E-MANUAL** button.

Viewing the Contents

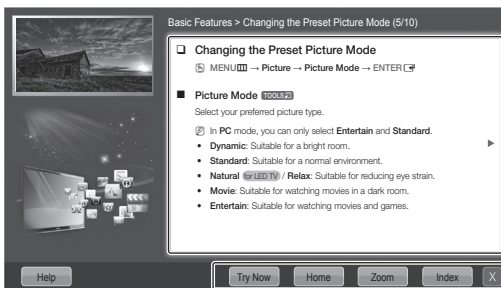

Contents Area: Contains the topic contents if you selected a sub-menu. To move to the previous or next page, press the ◀ or ▶ button.

Try Now: Displays the OSD menu that corresponds to the topic. To return to the e-Manual screen, press the e-Manual button

Home: Moves to the e-Manual home screen.

Zoom: Magnifies a screen.

Index: Displays index screen.



Using the Zoom mode

Select **Zoom**, and then press **ENTER** to magnify the screen. You can scroll through the magnified screen by using the **▲** or **▼** buttons.

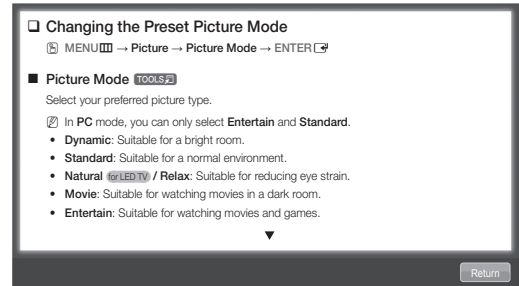
 To return to the screen to normal size, press the **RETURN**  button.



How to search for a topic on the index page

1. To search for a topic, press the left or right arrow button to select a letter, and then press **ENTER** . The Index displays a list of topics and keywords that begin with the letter you selected.
2. Press the up or down arrow button to select a character order you want, and then press the **ENTER**  button to select a topic you want to see.
3. The e-Manual page with the topic appears.

 To close the **Index** screen, press the **RETURN** button.

Troubleshooting

If the TV seems to have a problem, first review this list of possible problems and solutions. Also review the Troubleshooting section in the e-Manual. If none of the troubleshooting tips apply, visit "www.samsung.com," and then click on Support, or call Samsung customer service at 1-800-SAMSUNG.

Issues	Solutions and Explanations
The TV won't turn on.	<ul style="list-style-type: none"> • Make sure the AC power cord is securely plugged in to the wall outlet and the TV. • Make sure the wall outlet is working. • Try pressing the POWER button on the TV to make sure the problem is not the remote. If the TV turns on, refer to "Remote control does not work" below.
There is no picture/video.	<ul style="list-style-type: none"> • Check the cable connections. Remove and reconnect all cables connected to the TV and external devices. • Set the video outputs of your external devices (Cable/Sat Box, DVD, Blu-ray etc) to match the TV input connections. For example, if an external device's output is HDMI, it should be connected to an HDMI input on the TV. • Make sure your connected devices are powered on. • Be sure to select the correct input source by pressing the SOURCE button on the remote control. • Reboot the connected device by unplugging and then reconnecting the device's power cable.
The remote control does not work.	<ul style="list-style-type: none"> • Replace the remote control batteries. Make sure the batteries are installed with their poles (+/-) in the correct direction. • Clean the sensor's transmission window on the remote. • Try pointing the remote directly at the TV from 5~6 feet away.
The cable/set top box remote control doesn't turn the TV on or off, or adjust the volume.	<ul style="list-style-type: none"> • Program the Cable/Set remote control to operate the TV. Refer to the Cable/Set user manual for the SAMSUNG TV code.

 This TFT LED panel uses a panel consisting of sub pixels which require sophisticated technology to produce. However, there may be a few bright or dark pixels on the screen. These pixels will have no impact on the performance of the product.

 You can keep your TV as optimum condition to upgrade the latest firmware on web site (samsung.com → Support → Downloads) by USB.

License



List of Features

- **Excellent Digital Interface & Networking:** Using its built-in HD digital tuner, you can view non-subscription HD broadcasts without a cable box or STB (Set-Top-Box) satellite receiver.
- **3D:** This exciting new feature enables you to view 3D content.
- **SMART HUB:** Your Gateway to all your content, integrated in one place
 - Provides diverse entertainment choices.
 - Lets you control your entertainment life with an easy-to-use, user friendly UI.
 - Gives you easy access to diverse Apps, with more being added every day.
 - Lets you customize your TV by grouping and sorting Apps to your taste.
- **AllShare™:** AllShare™ connects your TV and compatible Samsung mobile phones/devices through a network.
- **Anynet+(HDMI-CEC):** Allows you to control all connected Samsung devices that support anynet+ with your Samsung TV's remote.

Securing the TV to the Wall



Caution: Pulling, pushing, or climbing on the TV may cause the TV to fall. In particular, ensure your children do not hang over or destabilize the TV. Doing so may cause the TV to tip over, causing serious injuries or death. Follow all safety precautions provided in the included Safety Flyer with your TV. For added stability and safety, you can purchase and install the anti fall device as described below.

The TV-Holder Kit (Sold Separately):

The parts below are included in the TV Holder kit. In addition, you need to provide a wood screw, screw and molly, or other screw appropriate for the wall or cabinet you intend to secure the TV-Holder string to. We recommend a size M4xL20 wood screw.



TV-Holder (BN96-15753A)



Screw (M8 X L19)

Installing the TV-Holder

1. Remove the screw attached to the back of your TV, and then connect the TV-Holder to the TV with the screw included in the TV-Holder Kit that is designated for your TV.

 Make sure to use only the appropriate supplied screw. If you use a different screw, you can damage your TV.

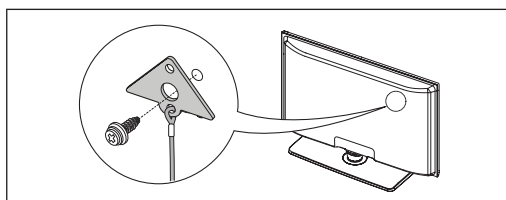

2. Firmly fasten the screw you provided (size M4xL20 or similar) to the wall or cabinet where the TV is to be installed.

 If you fasten the screw to the wall, we recommend you drive the screw into a stud. If that is not possible, use a molly to anchor the screw.

3. Tie the TV-Holder cord to the screw fastened on the wall or cabinet so that the TV is fixed. See the illustrations below.

 Install the TV close to the wall so that it does not fall.

 When attaching the TV-Holder cord to the wall, tie the cord level with the ground or slanted downwards for safety purposes.

 Check the cord occasionally to make sure it is secure.

 Before moving the TV, separate the connected cord first.

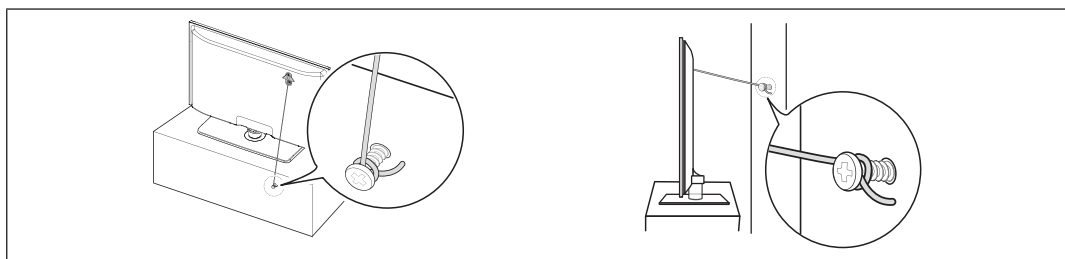

4. Verify all connections are properly secured. Periodically check the connections for any sign of fatigue or failure. If you have any doubt about the security of your connections, contact a professional installer.

To purchase the TV-Holder Kit, contact Samsung Customer Care

- In the United States: 1-800-SAMSUNG (1-800-726-7864)
- In Canada: 1-800-SAMSUNG (1-800-726-7864)

Securing the Installation Space

Keep the required distances between the TV, the wall, and other objects to ensure proper ventilation. Failing to do so may result in a fire or a problem with the TV caused by an increase in its internal temperature.

- ✎ When using a stand or wall-mount, use parts provided by Samsung Electronics only.
 - If you use parts provided by another manufacturer, it may result in a problem with the product or an injury due to the product falling.

Installation with a stand.

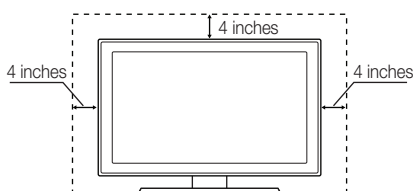

Installation with a wall-mount.

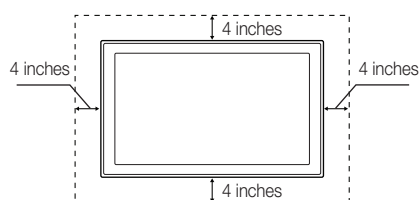

Other Warnings

- ✎ The actual appearance of the TV may differ from the images in this manual, depending on the model.
- ✎ Be careful when you touch the TV. Some parts can be somewhat hot.

Storage and Maintenance

- ✎ If you attached some stickers on the TV screen, it remains some debris after removing the sticker. Please clean it to watch TV.



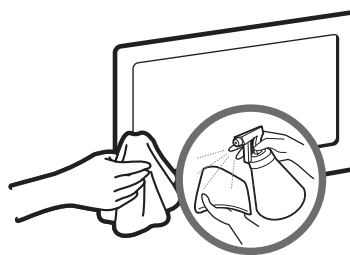

Do not spray water or a cleaning agent directly onto the product. Any liquid that goes into the product may cause a failure, fire, or electric shock.



Clean the product with a soft cloth dampened with a small amount of water.

Specifications

Display Resolution	1920 x 1080	
Environmental Considerations		
Operating Temperature	50°F to 104°F (10°C to 40°C)	
Operating Humidity	10% to 80%, non-condensing	
Storage Temperature	-4°F to 113°F (-20°C to 45°C)	
Storage Humidity	5% to 95%, non-condensing	
Stand Swivel (Left / Right)	-20° ~ 20°	
Model Name	UN40D6400 / UN40D6450	UN46D6400 / UN46D6450
Screen Size (Diagonal)	40" Class (40.0" measured diagonally)	46" Class (45.9" measured diagonally)
Sound (Output)	10W X 2	
Dimensions (WxDxH)		
Body	36.6 X 1.2 X 21.5 inches (929.5 X 29.9 X 545.3 mm)	41.9 X 1.2 X 24.5 inches (1064.9 X 29.9 X 621.7 mm)
With stand	36.6 X 10.0 X 23.9 inches (929.5 X 255.0 X 606.4 mm)	41.9 X 10.8 X 26.9 inches (1064.9 X 275.0 X 682.8 mm)
Weight		
Without Stand	22 lbs (10.0 kg)	26.5 lbs (12.0 kg)
With Stand	27.6 lbs (12.5 kg)	35.7 lbs (16.2 kg)
Model Name	UN55D6400 / UN55D6450	
Screen Size (Diagonal)	55" Class (54.6" measured diagonally)	
Sound (Output)	15W X 2	
Dimensions (WxDxH)		
Body	49.4 X 1.2 X 28.7 inches (1255.3 x 29.9 x 728.3 mm)	
With stand	49.4 X 10.8 X 31.8 inches (1255.3 x 275.0 x 808.4 mm)	
Weight		
Without Stand	38.1 lbs (17.3 kg)	
With Stand	48.5 lbs (22.0 kg)	

-  Design and specifications are subject to change without prior notice.
-  This device is a Class B digital apparatus.
-  For information about the power supply, and more about power consumption, refer to the label attached to the product.

Dispose unwanted electronics through an approved recycler.

To find the nearest recycling location, go to our website:

www.samsung.com/recyclingdirect Or call, (877) 278 - 0799

Dimensions

■ Front view / Side view

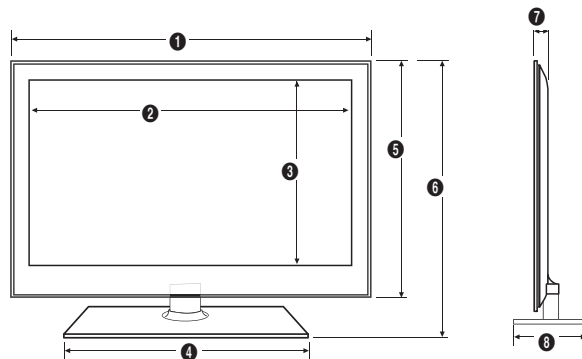

(Unit: inches)

Model name	1	2	3	4	5	6	7	8
UN40D6400 UN40D6450	36.6	35.1	19.9	18.9	21.5	23.9	1.2	10.0
UN46D6400 UN46D6450	41.9	40.4	22.9	19.5	24.5	26.9	1.2	10.8
UN55D6400 UN55D6450	49.4	47.9	29.4	19.5	28.7	31.8	1.2	10.8

■ Jack panel detail / Rear view

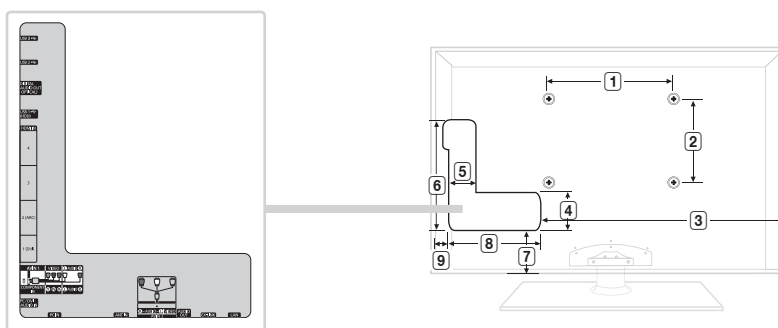

(Unit: inches)

Model name	1	2	3	4	5	6	7	8	9
UN40D6400 UN40D6450	7.9	7.9	23.2	3.7	4.1	13.0	4.0	11.1	1.9
UN46D6400 UN46D6450	15.7	15.7	28.1	4.3	3.7	13.6	4.0	12.1	2.0
UN55D6400 UN55D6450	15.7	15.7	33.7	4.4	4.9	14.6	4.0	14.0	1.9

NOTE: All drawings are not necessarily to scale. Some dimensions are subject to change without prior notice. Refer to the dimensions prior to performing installation of your TV. Not responsible for typographical or printed errors.

© 2011 Samsung Electronics America, Inc

***This page is intentionally
left blank.***